

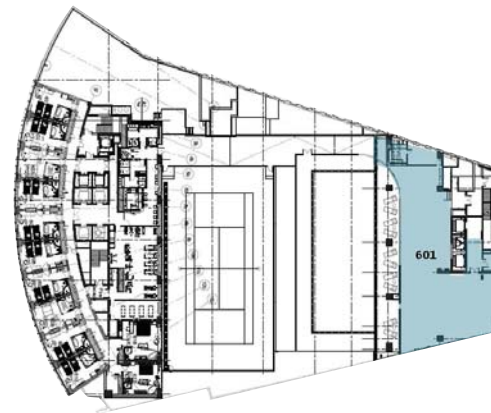

The Amara Group

Sharing a common vision and an identical set of values, we strive to deliver a brand experience unique to Amara in our three interrelated core businesses – Hotel Investment & Management, Property Investment & Development, Specialty Restaurants & Food Services. The Amara Vision is to be recognised as a leading Asian integrated lifestyle group, with premium brands that exude the value, quality and style of our product offerings, and a warm and personalised service that goes beyond the expectations of our customers.

6F 雪茄会所 Cigar Club



5F 精致影院 Cinema



3F 精致影院 高档餐饮
Cinema and Fine Dining



2F 儿童教育 体验培训
Enrichment Centres & Experiential Training



1F 风情餐饮 订制零售 休闲甜品
Restaurants, Retail and Desserts

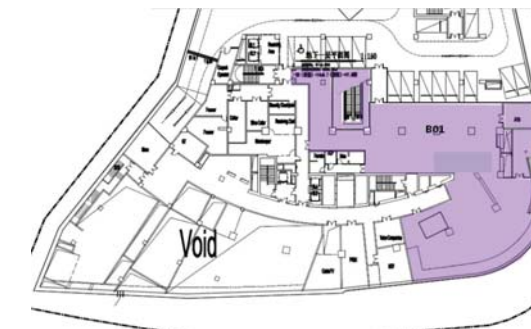

B1 美食广场 Dining Hall

* Enclosed floor plans are for reference only and are subject to the final approved documentation from the government and legal leasing agreement.

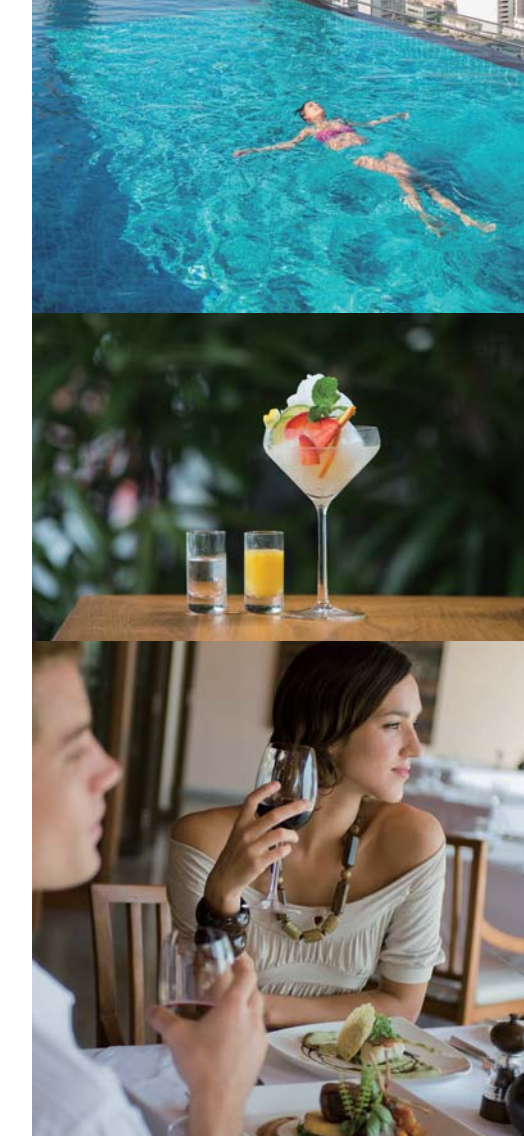

Arts • Exquisite • Innovative

Prime Location • CBD

5-Star Hotel

Chic and modern retail mall

High-end Offices





600 Changshou Road (junction of Jiaozhou Road), Putuo District, Shanghai

100 AM Shanghai is part of a mixed development, Amara Signature Shanghai, which will comprise a 343-room hotel, retail mall and office building. The mall will feature a myriad of great brands in food and beverages and entertainment as well as lifestyle retailers. The building will feature a carpark from B1 to B3 with over 190 carpark lots.

Hotel: 27 levels with a floor area of 36,000 square metres
100 AM Mall: 5 levels (with a basement level) and a floor area of 7,000 square metres
100 AM Offices: Level 7 to 11 with a floor area of 4,600 square metres

The development is close to Jing'an district, as well as two huge bustling commercial districts – Caojiadu and Jing'an Temple. It sits along one of the main thoroughfares, densely populated with private residential developments and easy access to public transportation, a mere 300 metres' walk from Subway Lines 7 and 13 providing direct access to the famous Zhongshan Park and Shanghai Railway Station.



**100
am** Mall
Offices

Address: 600 Changshou Road (junction of Jiaozhou Road) Putuo District, Shanghai
 Leasing Email: leasing@tlpgroups.com



Leasing Hotline:
 021-64266939
 021-64266936

AMARA
SIGNATURE
SHANGHAI



**100
am**

Mall
Offices

LEASING
INFORMATION

China . Shanghai